

Rated Voltage (Vac)	220
Rated Power (w)	400
Rated Torque (N.m)	1.27
Peak Torque (N.m)	3.81
Rated Speed (rpm)	3000
Peak Speed (rpm)	5000
Rated Current (Amp)	2.1
Peak Current (Amp)	6.5
Torque Const (N.m/Amp)	0.645
Back EMF Const (V/krpm)	39
Resistance (Ω)	5.7±10%
Inductance (mH)	12± 20%
Inertia (kg*m ² *10 ⁻⁴)	0.56
Poles	10
Encoder type	23bit optical
IP rating	IP67
Mass (Kg)	1.3

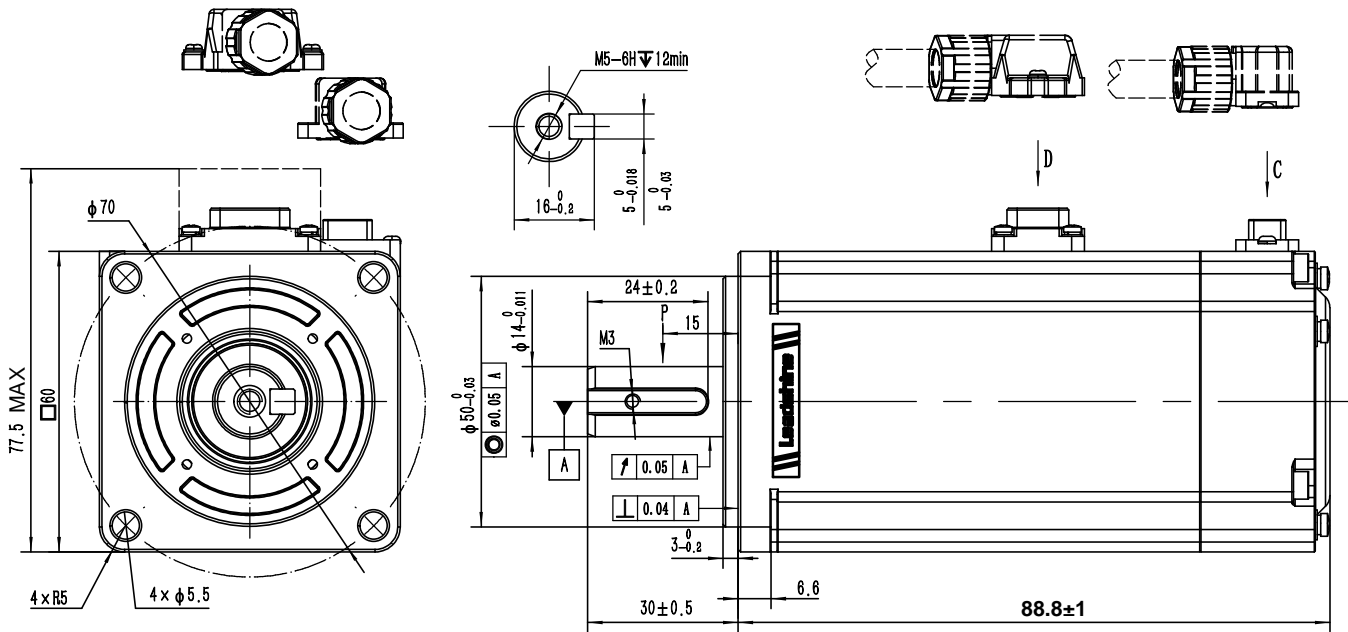

Wiring details of Power cable connector

Pos	1	2	3	4	--	--
Signal	U	V	W	PE	--	--

Wiring details of encoder cable connector

Pos	1	2	3	4	5	6	7
Signal	PE	5V	0V	SD+	SD-	Bat+	Bat-

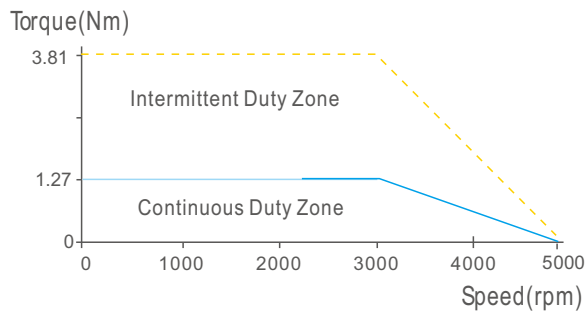

Leadshine Technology Co.,Ltd

ELM2H-0400LA60F

60mm, high inertia, 400 w servo motor
23bit optical encoder, no brake